

Health Sciences Research Building

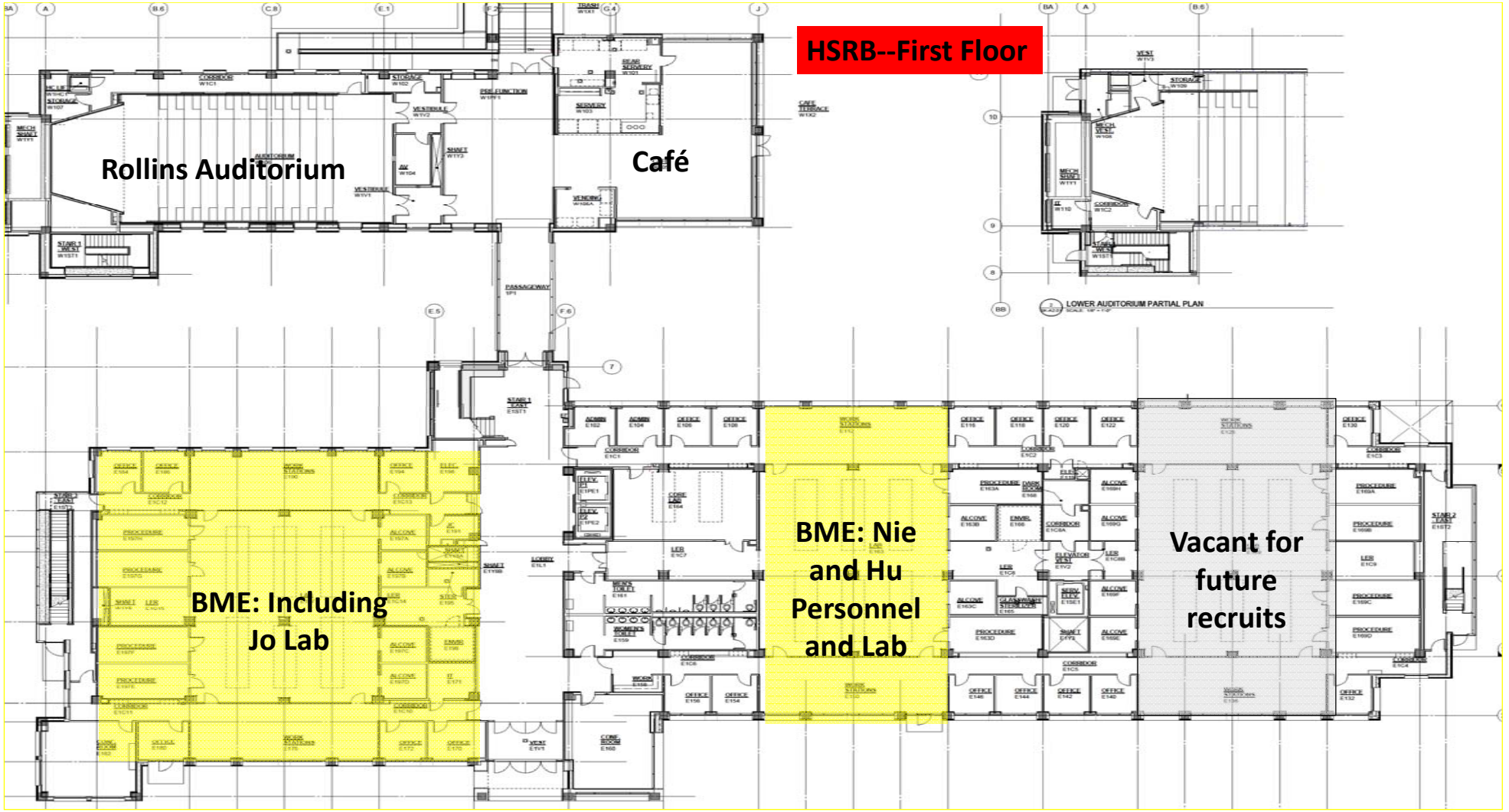

HSRB--First Floor

LOWER AUDITORIUM PARTIAL PLAN
SCALE: 1/8" = 1'-0"

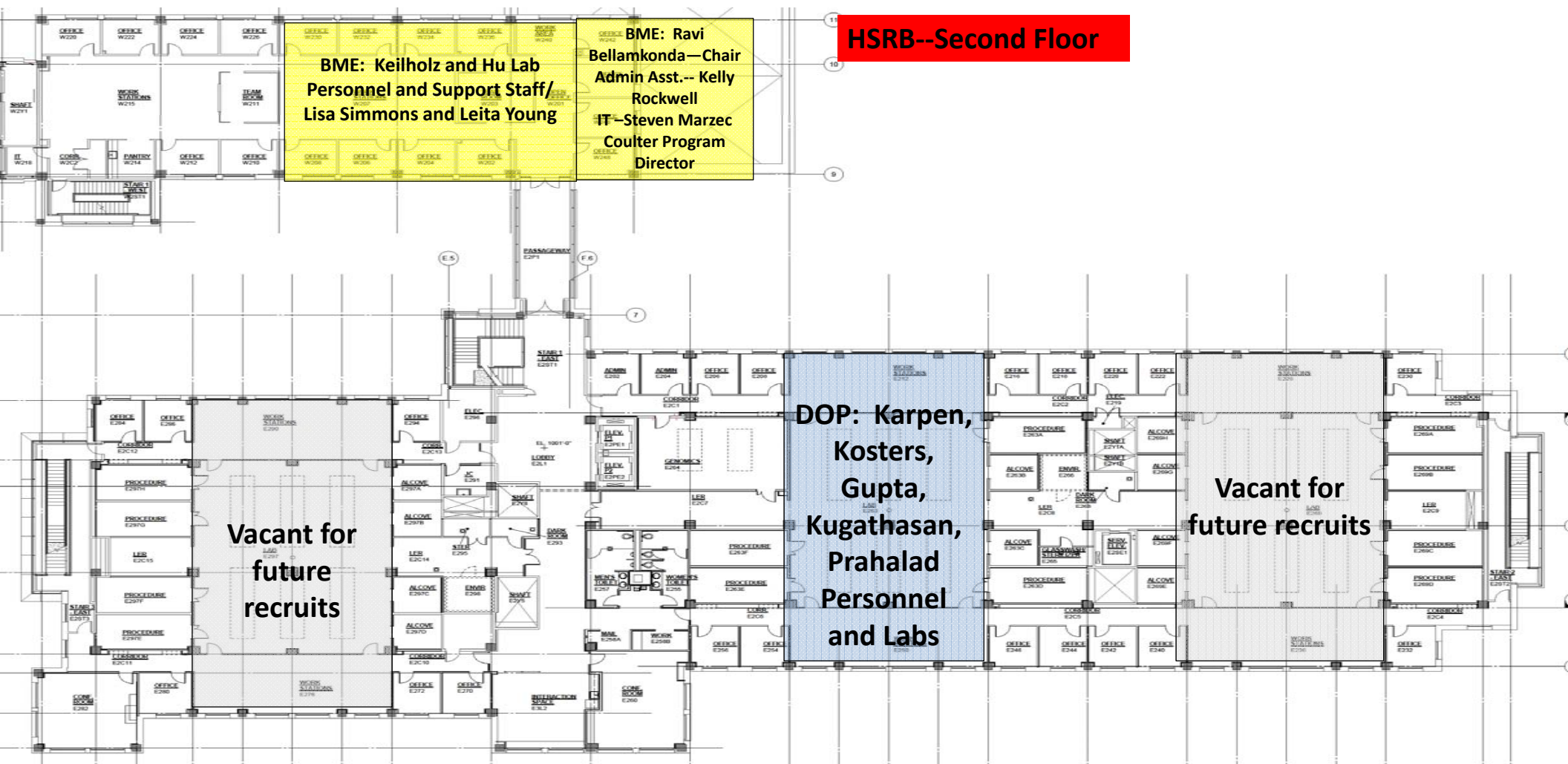

**BME: Keilholz and Hu Lab
Personnel and Support Staff/
Lisa Simmons and Leita Young**

**BME: Ravi
Bellamkonda—Chair
Admin Asst.-- Kelly
Rockwell
IT—Steven Marzec
Coulter Program
Director**

HSRB--Second Floor

**DOP: Karpén,
Kusters,
Gupta,
Kugathasan,
Prahalad
Personnel
and Labs**

**Vacant for
future
recruits**

**Vacant for
future recruits**

HSRB 3rd Floor Brumley Bridge Aflac Faculty

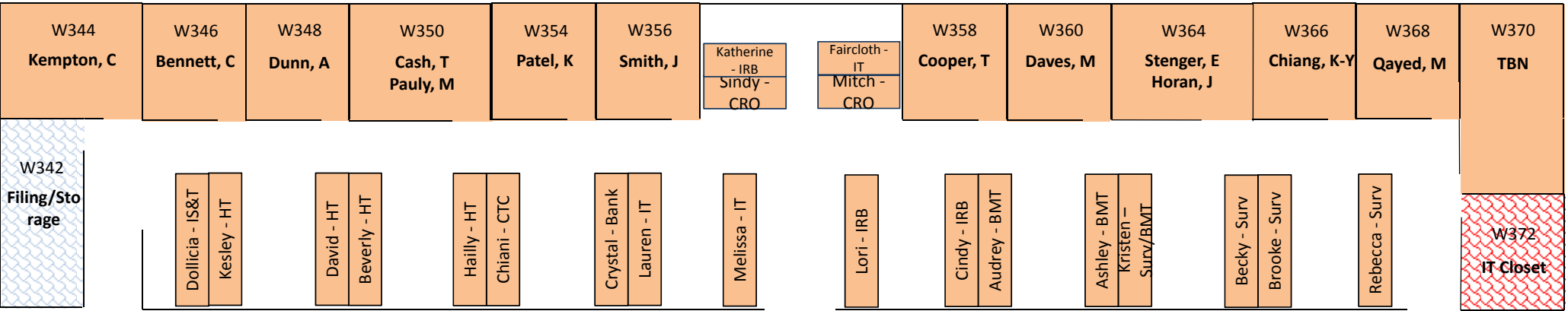

Aflac

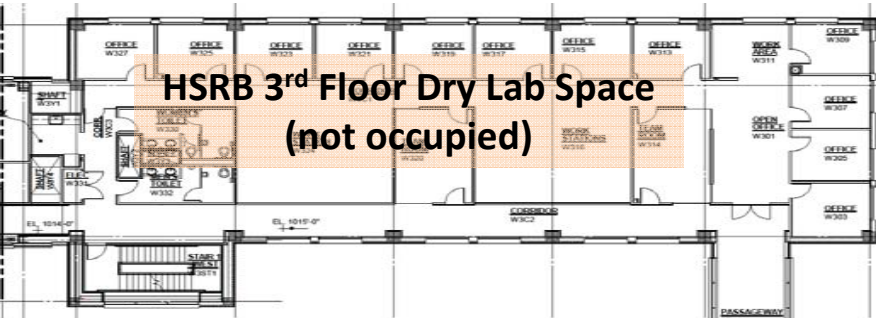

HSRB--Third Floor

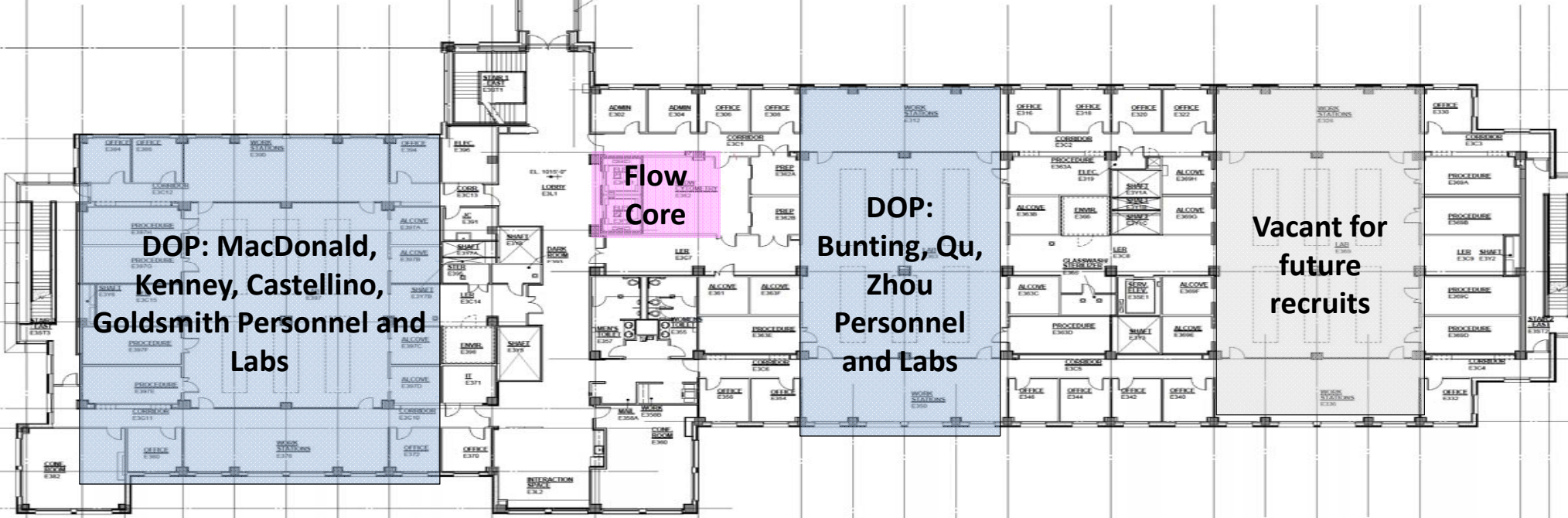

HSRB 4th Floor Brumley Bridge DOP—Outcomes Research

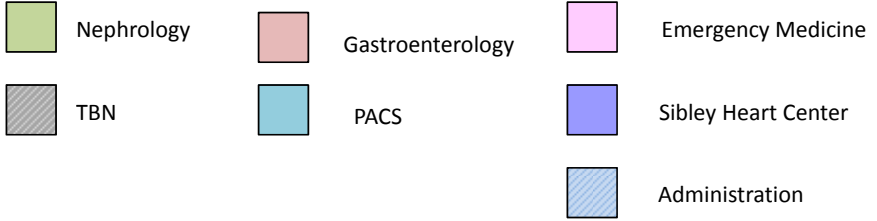
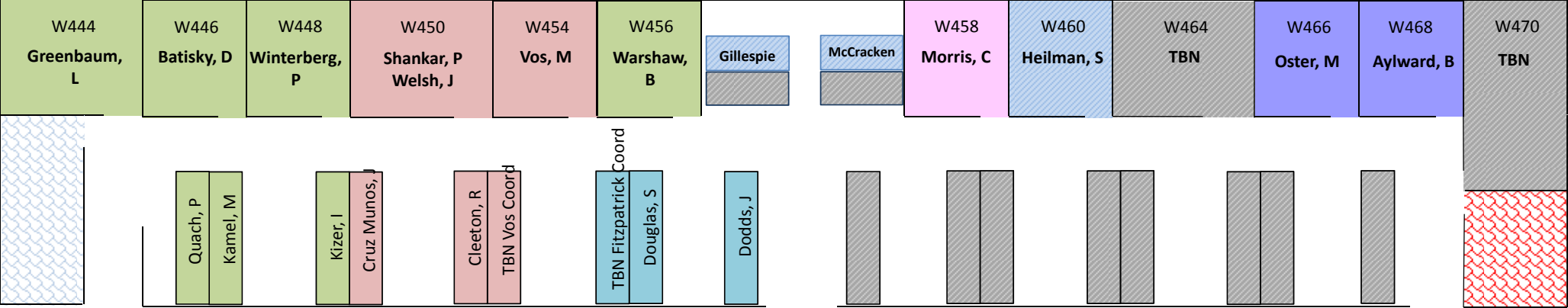

HSRB 4th Floor Dry Lab Space--DOP

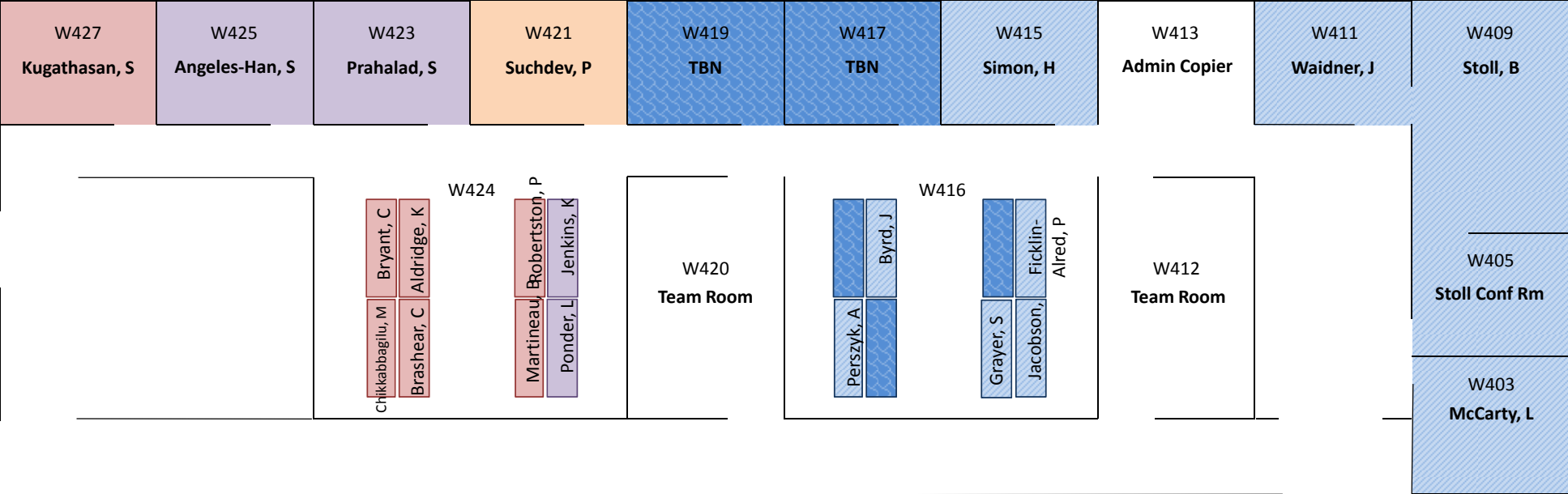

- TBN - Admin
- Rheumatology
- DOP Admin
- Gastroenterology
- General Pediatrics

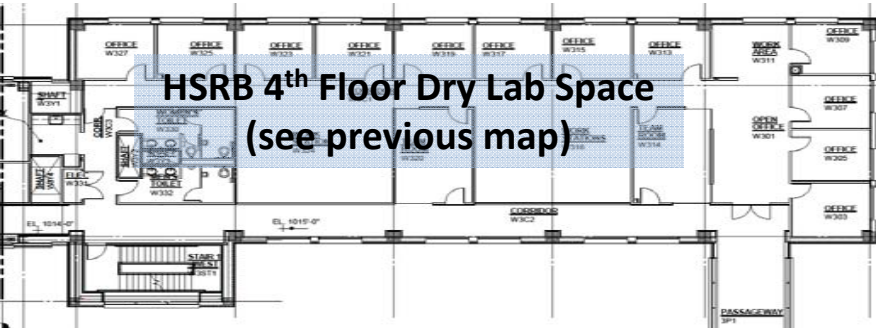

**HSRB 4th Floor Dry Lab Space
(see previous map)**

HSRB—Fourth Floor

←-----Raymond Schinazi Floor-----→

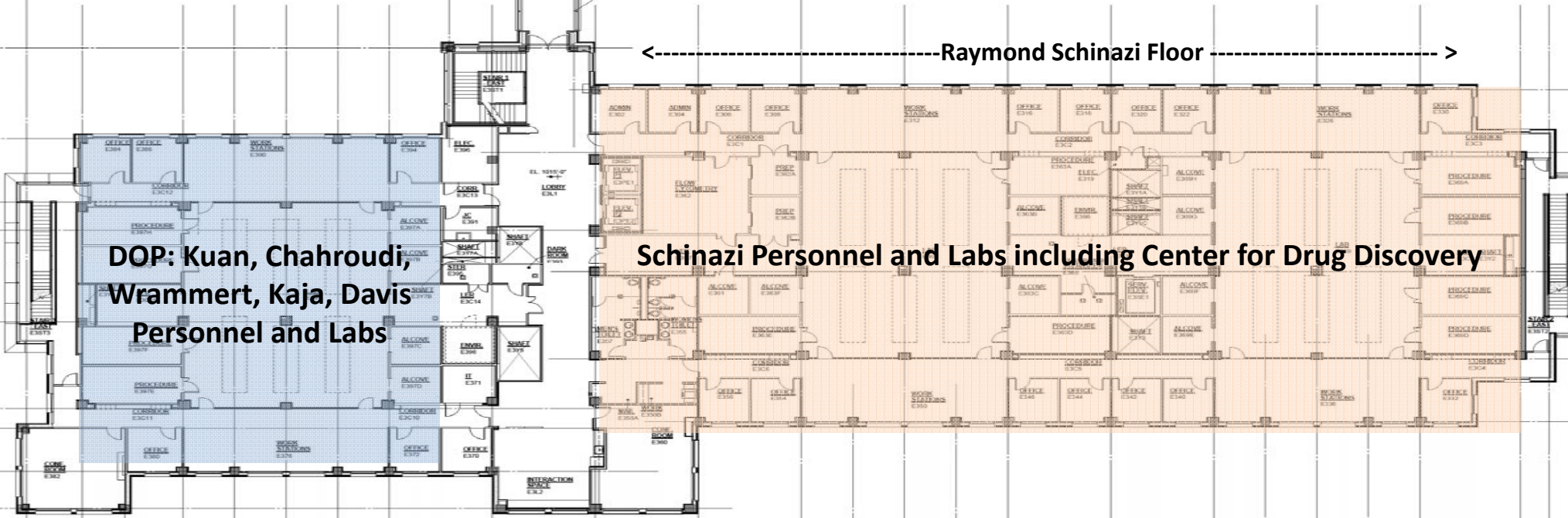

**DOP: Kuan, Chahroudi,
Wrarmert, Kaja, Davis
Personnel and Labs**

Schinazi Personnel and Labs including Center for Drug Discovery

HSRB 3rd Floor Dry Lab Space--Vacant for future recruits

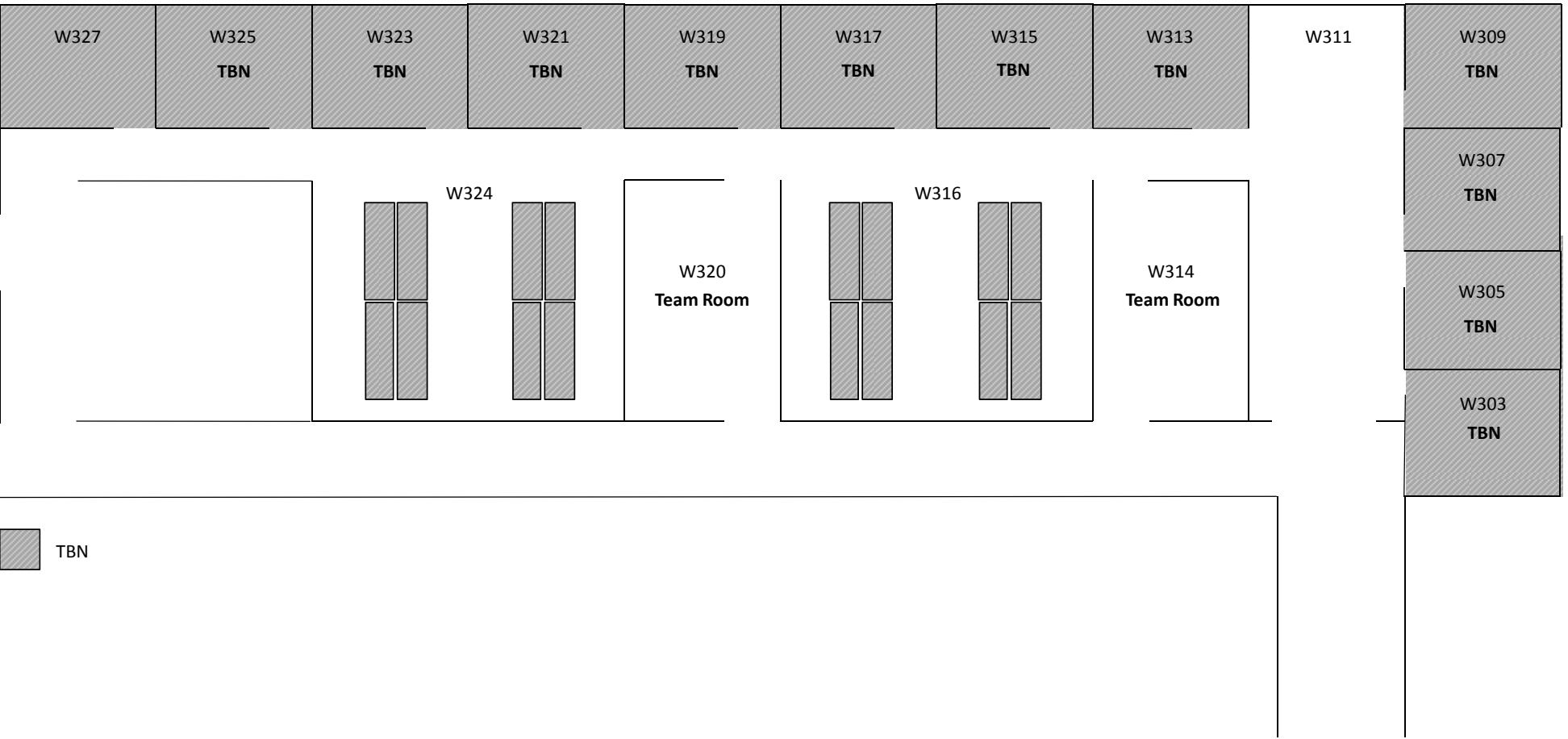

 TBN