



EMORY  
UNIVERSITY  
SCHOOL OF  
MEDICINE



# THE 2ND ANNUAL EMORY PHYSICIAN SCIENTIST *Symposium*

APRIL 4, 2025

HSRB I & II



R38HL167243

# AGENDA

8:30 – 9:00am HSRB I Café	Registration
9:00 – 9:10am HSRB I Auditorium	Opening Remarks  Deborah W. Bruner, RN, PhD, FAAN Senior Vice President for Research Emory University
9:10 – 9:50am HSRB I Auditorium	Cancer at the Crossroads: The Impact of Physician-Scientists  W. Kimryn Rathmell, MD, PhD 17 <sup>th</sup> Director of the National Cancer Institute National Institutes of Health
9:50 – 10:00am	Break
10:00 – 10:55am HSRB I Auditorium	Oral Presentations – Group 1  Development of a Novel Deep Learning Model for the Interpretation of Neonatal Radiographs Huang, Yixuan; <u>Sharma, Puneet</u> ; Palepu, Anil; Greenbaum, Nathaniel; Beam, Andrew; and Beam, Kristyn  Changes in Oral Antibiotic Prescribing Practices After Primary Total Knee Arthroplasty, 2009-2022 <u>Pisharody, Vivek</u> ; Fuqua, Andrew; Ayeni, Ayomide; Erens, Greg; Wilson, Jacob; and Premkumar, Ajay  CD26 CD4+ T cell expression is a prognostic and predictive biomarker in advanced melanoma <u>Swisher, Shannon</u> ; Wyatt, Megan; Wittling, Megen; Ruffin, Ayana; Delman, Keith; Lesinski, Gregory; Lowe, Michael; and Paulos, Chrystal  Impact of Right Ventricular Pacing Burden Among Patients with Transthyretin Cardiac Amyloidosis <u>Huang, Jingwen</u> ; Brown, Matthew T; Merchant, Faisal M; and Bhatt, Kunal N

11:00 – 12:15pm	<p>Breakout Session 1</p> <ul style="list-style-type: none"> <li>Panel 1: Timelines to Funding for Early Career Physician Scientists <ul style="list-style-type: none"> <li>Session Leaders: W. Robert Taylor and Patricia Zerra</li> <li>Room: HSRB I Auditorium</li> </ul> </li> <li>Panel 2: Navigating Academic Service Opportunities <ul style="list-style-type: none"> <li>Session Leaders: Jason Yustein and David Yu</li> <li>Room: HSRB II N600</li> </ul> </li> <li>Panel 3: Emory Research Services Speed Dating <ul style="list-style-type: none"> <li>Session Leaders: Greg Lesinski and Adam Marcus</li> <li>Room: HSRB II N100</li> </ul> </li> </ul>
12:15 – 1:00pm HSRB I Café	Grab and Go Lunch
1:10 – 1:50pm HSRB I Auditorium	My Journey from the Slaughterhouse to Alzheimer's Disease
	<p>Allan Levey, MD, PhD  Robert W. Woodruff Professor of Neurology  Director, Emory Goizueta Alzheimer's Disease Research Center  Director, Goizueta Brain Health Institute</p>
1:50 – 2:00pm	Break
2:00 – 2:55pm HSRB I Auditorium	Oral Presentations – Group 2
	<p>Determination of tumor PSMA expression and Lutetium-PSMA response in men with prostate cancer using a novel epigenomic liquid biopsy platform  Ravi, P; D'Ippolito, A; Wurster, J; Kramer, N; Painter, C; Gorthi, A; Eaton, M; Barrett, C; Jacene, H; and <u>Berchuck, Jacob</u>.</p> <p>Investigating ER Stress-driven Vascular Remodeling in a Novel 3D-Bioprinted Pulmonary Arterial Hypertension Model  <u>Kaw, Kaveeta</u>; Saadeh, Maher; DeBord, Wyatt; Tomov, Martin; Parab, Manasvi; Vel, Suhana; Do, Lena; Serpooshan, Vahid; and Bauser-Heaton, Holly.</p> <p>Adjuvant IL15 Blockade Significantly Improves Survival When Combined With a Costimulation-Based Immunosuppression Protocol in Pig-to-Nonhuman Primate Renal Xenotransplantation  <u>Keiler, James A</u>; Habib, Jakob; Han, Ji; Wilson, Bobbi; Guo, Lizheng; Farris, Alton B; Jenkins, Joe; Whitworth, Kristin; Moore, Ian; Ford, Mandy; Johnson, Paul; Larsen, Christian; Kitchens, William; and Kim, Steven C.</p> <p>Sepsis Enhances Establishment and Growth of Murine Intestinal Organoids  <u>Straub, Evan</u>; Prasad Jalaja, Prijji; Chen, Ching-Wen; Yang, Chloe; and Lyons, John</p>

3:00 – 4:15pm	Breakout Session 2
	<ul style="list-style-type: none"> <li>Panel 1: Trainee to Trainee – Making the Most of your Research During Training <ul style="list-style-type: none"> <li>Session Leaders: Physician Scientist Trainees from across SOM</li> <li>Room: HSRB II N100</li> </ul> </li> <li>Panel 2: Manuscript Pitching, Writing &amp; Publishing <ul style="list-style-type: none"> <li>Session Leaders: Guido Silvestri and Jonathan Sevransky</li> <li>Room: HSRB I Auditorium</li> </ul> </li> <li>Panel 3: How to Mentor and Be Mentored <ul style="list-style-type: none"> <li>Session Leaders: Kathy Griendling and Sushma Cribbs</li> <li>Room: HSRB II N600</li> </ul> </li> </ul>
4:15 – 5:30pm HSRB II Atrium	Poster Session + Reception <i>5:15pm - Presentation of awards</i>
	<p><b>Ann Chahroudi, MD, PhD</b>  Professor and Vice Chair for Basic Science Research and Career Development  Department of Pediatrics, Emory University School of Medicine  Training Director, Atlanta Pediatric Scholars K12 Program  MPI, Emory T32 Training Program in Translational Research to End the HIV Epidemic  Co-PI, Emory Pediatrics and Pathology Stimulating Access to Research in Residency R38 Program  Co-Director, Pediatric Residency Investigative Scholars at Emory (PRISE) Program</p>

## HSRB I & II FLOORPLANS

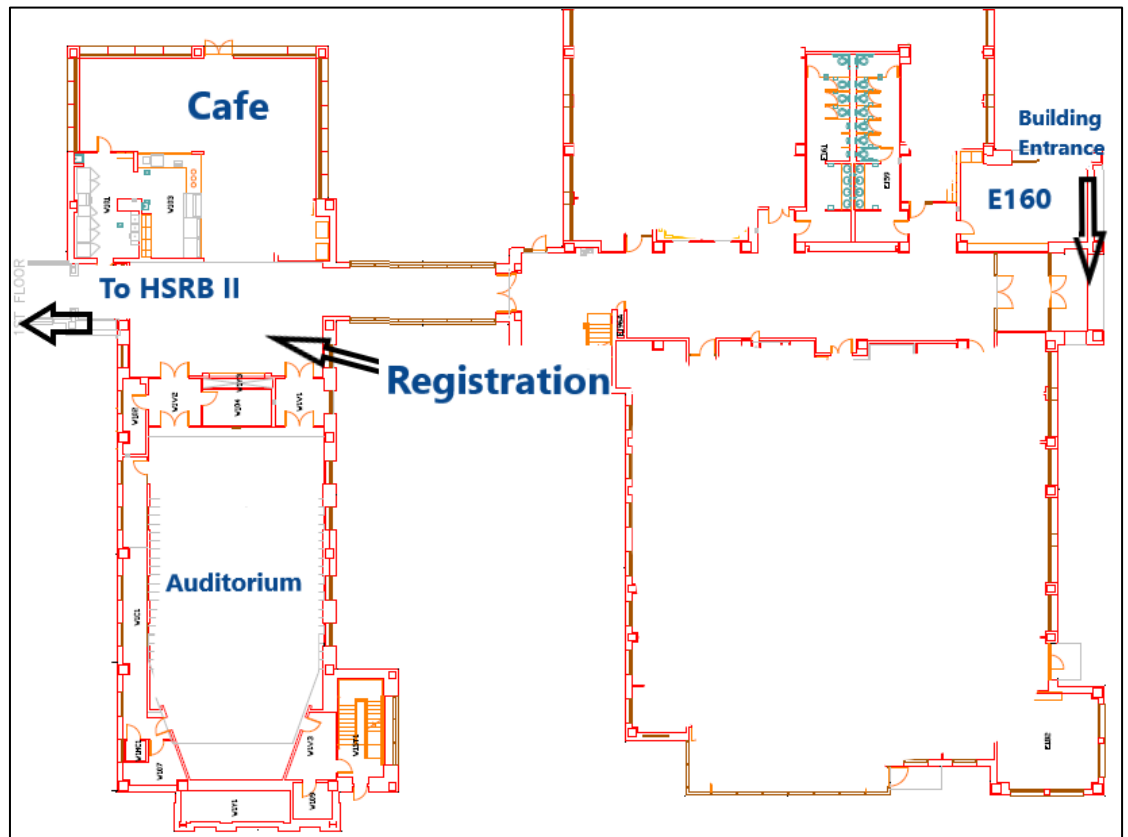
**HSRB I**

## HSRB II

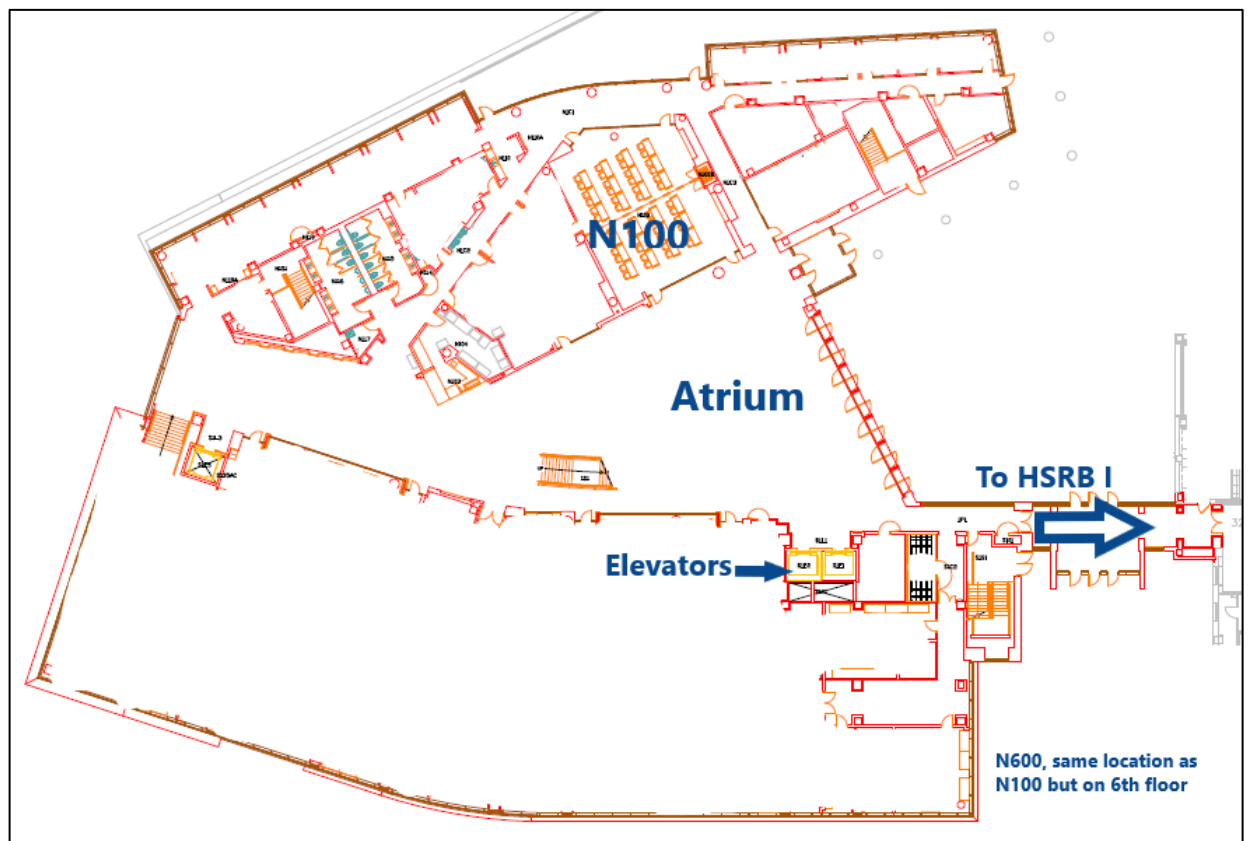

## KEYNOTE SPEAKERS



W. Kimryn Rathmell, M.D., Ph.D., M.M.H.C., was sworn in as the 17th NCI director on December 18, 2023, and stepped down from that role on January 20, 2025. She previously led the Vanderbilt University Medical Center as physician-in-chief and chair of the Department of Medicine. Dr. Rathmell is a recipient of the American Cancer Society Medal of Honor, the Louisa Nelson Award for Women of Achievement, Vision, and Inspiration, the Eugene P. Schonfeld Award from the Kidney Cancer Association, and the Paragon Award for Research Excellence from the Doris Duke Foundation. She was a leader of The Cancer Genome Atlas's (TCGA) kidney cancer projects

and served as a TCGA analysis working group member across the spectrum of cancers, winning the 2020 American Association for Cancer Research Team Science Award. She has served on the NCI Board of Scientific Advisors, and the Forbeck Foundation Scientific Advisory Board.

Dr. Rathmell has held leadership positions with the American Society of Clinical Oncology and the American Society for Clinical Investigation, serving as secretary-treasurer and president. As a result of her efforts, Dr. Rathmell has been elected to the Association of American Physicians, the American Academy of Arts and Sciences, and the National Academy of Medicine. Dr. Rathmell's specialty is the research and treatment of complex and hereditary kidney cancers. She also focuses on underlying drivers of kidney cancers using genetic, molecular, and cell biology to develop interventions to improve patients' lives. Dr. Rathmell's research has resulted in more than 300 articles in leading peer-reviewed journals, including The New England Journal of Medicine, Nature, Proceedings of the National Academy of Sciences, and the Journal of Clinical Investigation. Dr. Rathmell earned undergraduate degrees in biology and chemistry from the University of Northern Iowa and her Ph.D. in biophysics and M.D. from Stanford University. She completed an internal medicine internship at the University of Chicago and an internal medicine residency, medical oncology fellowship, and postdoctoral studies at the University of Pennsylvania. In 2022, she completed her Master of Management in Health Care from the Vanderbilt University Owen Graduate School of Management.



Dr. Allan Levey is the Robert W. Woodruff Professor and Director of the Goizueta Alzheimer's Disease Research Center and the Goizueta Institute at Emory University. Dr. Levey received a BS from University of Michigan and an MD and PhD (Immunology) from the University of Chicago. He then trained in Neurology at Johns Hopkins and joined their faculty prior to moving to Emory in 1991. He Chaired the Emory Department of Neurology from 2003-2021, leading it to be among the top NIH funded research departments with a major expansion of the faculty and the clinical and educational programs. Dr. Levey is a neurologist and neuroscientist internationally recognized for his work in Alzheimer's Disease, related neurodegenerative disorders, investigating disease mechanisms and translation to new therapeutic strategies and biomarkers. He leads multi-institutional teams in NIH translational programs, including Accelerating Medicine Partnership for Alzheimer's Disease and the TREAT-AD

consortia, and he is a steering committee member for the AD clinical trials programs. His research has produced more than 500 publications with 50,000+ citations and an H index of 122, funded by grants from the NIH totaling more than \$125 million. He has received numerous awards and is a member of the National Academy of Medicine.



## BREAKOUT SESSIONS

### Session 1 – 11:00am – 12:15pm

#### Panel 1: Timelines to Funding for Early Career Physician Scientists

Room: HSRB II N600

Session Leaders:

W. Robert Taylor, MD, PhD, Associate Dean for Clinical Research, Georgia Clinical & Translational Science Alliance

Patricia Zerra, MD, Assistant Professor, Department of Pathology and Laboratory Medicine

Description: This session reviews grants and the timelines that are open to early career scholars, including those from federal and non-federal sources.

#### Panel 2: Navigating Academic Service Opportunities

Room: HSRB I Auditorium

Session Leaders:

Jason Yustein, MD, PhD, Director, Medical Scientist Training Program, School of Medicine

David Yu, MD, PhD, Vice Chair for Biology Research, Department of Radiation Oncology

Description: This session will focus on how to choose your service involvement wisely at the institutional and national level to advance your career.

#### Panel 3: Making the Most of Emory's Research Services

Room: HSRB II N100

Session Leaders:

Greg Lesinski, PhD, Associate Director for Basic Research, Winship Cancer Institute

Adam Marcus, PhD, Senior Associate Dean of Research, School of Medicine

Joshua Brown, MD, PhD, Creator, [Connectogen](#): Centralized Platform for Academic Collaborations

Description: In this session you will learn about the core facilities available to researchers at Emory. These core facilities offer services that span basic, translational, clinical, and community-engaged research.

## Session 2 – 3:00pm – 4:15pm

### Panel 1: Trainee to Trainee – Making the Most of your Research During Training

Room: HSRB II N100

Session Leaders:

Ann Chahroudi, MD, PhD, Vice Chair for Basic Science Research, Department of Pediatrics

Rebecca Levit, MD, PhD, Associate Professor, Department of Medicine

Physician Scientist Trainees from across SOM

Description: Panelists will offer advice to other trainees, with a special focus on pre-med and medical students, about balancing the demands of research and clinical training.

### Panel 2: Manuscript Pitching, Writing & Publishing

Room: HSRB I Auditorium

Session Leaders:

Guido Silvestri, MD, Vice President for Basic and Translational Research, Woodruff Health Sciences Center

Jonathan Sevransky, MD, MHS, Professor, Department of Medicine; Editor-in-Chief, *Critical Care Medicine*

Description: This session reviews the ins and outs of peer-reviewed publishing with particular focus on the questions many early career scholars have about the publishing process.

### Panel 3: How to Mentor and Be Mentored

Room: HSRB II N600

Session Leaders:

Kathy Griendling, PhD, Executive Associate Dean, Faculty Affairs and Professional Development, School of Medicine

Sushma Cribbs, MD, MSc, Professor, Department of Medicine

Description: During this session, we will discuss critical aspects of the mentoring relationship, focusing on communication and expectations. We will use case-based discussions and take a deep dive into communication styles to help you get the most of your mentoring relationship, whether you are the mentor or the mentee.



## ACKNOWLEDGEMENTS

Thank you to the [National Heart Lung and Blood Institute](#) through the Emory Pediatrics and Pathology Stimulating Access to Research in Residency Program (R38HL167243), as well as to the [Emory School of Medicine Dean's Office](#) and the [Department of Pediatrics](#), for their sponsorship of this event.

Thank you to the [symposium organizing committee](#) and the trainee research programs they represent.

---

Ann Chahroudi, MD, PhD Department of Pediatrics	David Goldsmith, MD Department of Psychiatry and Behavioral Sciences	Cheryl Meier, MD, PhD Department of Pathology
John Roback, MD, PhD Department of Pathology	Benjamin Kopp, MD, MPH Department of Pediatrics	Brian Robinson, MD, PhD Department of Pathology
Holly Bauser-Heaton, MD, PhD Department of Pediatrics	Rebecca Levit, MD Department of Medicine	David Yu, MD, PhD Department of Radiation Oncology
Todd Golde, MD, PhD Department of Pharmacology	Michael Lowe, MD Department of Surgery	

Thank you to our abstract reviewers.

---

Jaimo Ahn, MD, PhD	Steven Kim, MD	Amir Rezvan, MD
Muath Bishawi, MD, PhD	Jean Koff, MD, MSc	Lisa Sudmeier, MD, PhD
David Gutman, MD, PhD	Puja Mehta, MD	Eli Wilber, MD
Craig Coopersmith, MD	Svjetlana Miocinovic, MD, PhD	W. Wyatt Wilson, MD
Apama Kesarwala, MD, PhD	Anne Piantadosi, MD, PhD	Patricia Zerra, MD
	Sunil Raikar, MD	

Finally, thank you to the [staff and vendors](#) who made this event possible.

---

Megan Vallowe, PhD

Kanika Chatkara

Marco Aguilar

Terra Joyce

Courtney Marshall (HSRB II)

Maurice Lynch (AV)

Mike Thurman (AV)

Proof in the Pudding

Candler Park Market